

# 7 NEIL AVENUE LOCAL

## MONDAY-FRIDAY NORTH

1	2	3	4	5	6	7	8
S. HIGH & E. BROAD	HIGH & NATIONWIDE	COLLINS & THURBER	NEIL & 5TH	12TH & CANCER CLINIC	COLLEGE & 12TH	WOODRUFF & COLLEGE	UNIVERSITY CITY
5.07	5.10	5.17	5.22	5.28	5.31	5.34	5.43
5.30	5.34	5.41	5.46	5.52	5.55	5.58	6.08
5.50	5.54	6.01	6.06	6.13	6.16	6.19	6.29
6.10	6.14	6.22	6.27	6.34	6.37	6.41	6.51
6.25	6.29	6.37	6.42	6.50	6.53	6.57	7.07
6.48	6.52	7.01	7.07	7.15	7.19	7.22	7.32
7.10	7.14	7.23	7.29	7.37	7.41	7.44	7.54
7.30	7.34	7.43	7.49	7.57	8.02	8.05	8.15
7.50	7.54	8.03	8.09	8.17	8.21	8.24	8.34
8.10	8.14	8.23	8.28	8.36	8.40	8.43	8.53
8.30	8.34	8.43	8.48	8.55	8.59	9.02	9.11
8.50	8.54	9.02	9.07	9.14	9.18	9.21	9.30
9.20	9.24	9.32	9.37	9.44	9.48	9.51	10.00
9.50	9.54	10.02	10.07	10.14	10.18	10.21	10.29
10.15	10.19	10.27	10.32	10.39	10.43	10.46	10.54
10.45	10.49	10.58	11.03	11.10	11.14	11.17	11.25
11.15	11.19	11.28	11.33	11.40	11.44	11.47	11.55
11.45	11.49	11.58	12.03	12.10	12.14	12.17	12.26
<b>12.15</b>	<b>12.19</b>	<b>12.28</b>	<b>12.33</b>	<b>12.40</b>	<b>12.44</b>	<b>12.47</b>	<b>12.56</b>
<b>12.45</b>	<b>12.49</b>	<b>12.58</b>	<b>1.03</b>	<b>1.10</b>	<b>1.14</b>	<b>1.17</b>	<b>1.26</b>
1.15	1.19	1.28	1.33	1.40	1.44	1.47	1.55
1.45	1.49	1.58	2.03	2.10	2.14	2.17	2.25
2.13	2.17	2.26	2.31	2.38	2.42	2.45	2.54
2.35	2.39	2.48	2.53	3.00	3.04	3.07	3.16
2.50	2.54	3.03	3.08	3.15	3.19	3.23	3.33
3.15	3.19	3.28	3.33	3.40	3.44	3.48	3.58
3.35	3.39	3.48	3.53	4.00	4.04	4.08	4.17
3.55	3.59	4.08	4.13	4.20	4.24	4.28	4.37
4.15	4.19	4.28	4.33	4.40	4.44	4.48	4.57
4.35	4.39	4.48	4.53	5.00	5.05	5.09	5.18
4.54	4.58	5.07	5.12	5.19	5.24	5.28	5.37
5.15	5.19	5.28	5.33	5.40	5.44	5.48	5.57
5.45	5.49	5.58	6.03	6.10	6.14	6.18	6.27
6.05	6.09	6.18	6.23	6.30	6.34	6.38	6.47
6.40	6.44	6.53	6.58	7.04	7.08	7.11	7.20
7.10	7.14	7.23	7.28	7.34	7.38	7.41	7.50
7.38	7.42	7.50	7.55	8.01	8.04	8.07	8.16
8.20	8.24	8.32	8.37	8.43	8.46	8.49	8.58
9.05	9.09	9.17	9.22	9.28	9.31	9.34	9.43
10.00	10.04	10.12	10.17	10.23	10.26	10.29	10.38
10.45	10.49	10.57	11.02	11.08	11.11	11.14	11.23
11.45	11.49	11.57	12.02	12.08	12.11	12.14	12.23

## MONDAY-FRIDAY SOUTH

6	5	4	3	2	1
UNIVERSITY CITY	WOODRUFF & COLLEGE	COLLEGE & 12TH	12TH & CANCER CLINIC	NEIL & 5TH	COLLINS & THURBER
			5.25	5.29	5.35
			5.45	5.49	5.55
			6.05	6.09	6.15
			6.21	6.27	6.34
		6.13	6.21	6.27	6.34
			6.47	6.54	7.02
6.00	6.11	6.13	6.41	6.47	6.54
6.20	6.31	6.33	6.41	6.47	6.54
6.40	6.51	6.53	7.02	7.07	7.14
6.59	7.11	7.13	7.22	7.27	7.34
7.19	7.31	7.33	7.42	7.47	7.54
7.41	7.53	7.56	8.05	8.09	8.16
8.02	8.14	8.17	8.26	8.30	8.37
8.22	8.34	8.37	8.45	8.49	8.55
8.41	8.54	8.57	9.05	9.09	9.15
9.11	9.24	9.27	9.35	9.39	9.45
9.41	9.54	9.57	10.05	10.09	10.15
10.11	10.24	10.27	10.35	10.39	10.45
10.41	10.54	10.57	11.05	11.09	11.15
11.11	11.24	11.27	11.35	11.39	11.45
11.41	11.54	11.57	12.05	12.09	12.15
<b>12.10</b>	<b>12.24</b>	<b>12.27</b>	<b>12.35</b>	<b>12.39</b>	<b>12.45</b>
<b>12.52</b>	<b>12.55</b>	<b>12.55</b>	<b>1.05</b>	<b>1.09</b>	<b>1.15</b>
1.25	1.29	1.33	1.39	1.46	1.50
1.38	1.51	1.54	2.03	2.08	2.14
2.14	2.21	2.25	2.30	2.36	2.43
2.47	2.54	2.58	3.03	3.08	3.14
3.05	3.12	3.16	3.21	3.27	3.34
3.38	3.45	3.49	3.54	3.60	3.67
3.70	3.77	3.81	3.86	3.92	3.99
4.02	4.09	4.13	4.18	4.24	4.31
4.43	4.50	4.54	4.59	4.65	4.72
4.83	4.90	4.94	4.99	5.05	5.12
5.34	5.41	5.45	5.50	5.56	5.63
6.04	6.11	6.15	6.20	6.26	6.33
6.44	6.51	6.55	6.60	6.66	6.73
7.04	7.11	7.15	7.20	7.26	7.33
7.41	7.48	7.52	7.57	7.63	7.70
8.01	8.08	8.12	8.17	8.23	8.30
8.41	8.48	8.52	8.57	8.63	8.70
8.81	8.88	8.92	8.97	9.03	9.10
9.11	9.18	9.22	9.27	9.33	9.40
9.51	9.58	9.62	9.67	9.73	9.80
10.01	10.08	10.12	10.17	10.23	10.30
10.41	10.48	10.52	10.57	10.63	10.70
11.01	11.08	11.12	11.17	11.23	11.30

## SATURDAY NORTH

1	2	3	4	5	6	7	8
S. HIGH & E. BROAD	HIGH & NATIONWIDE	COLLINS & THURBER	NEIL & 5TH	12TH & CANCER CLINIC	COLLEGE & 12TH	WOODRUFF & COLLEGE	UNIVERSITY CITY
6.15	6.19	6.24	6.30	6.35	6.38	6.40	6.47
7.00	7.04	7.09	7.15	7.20	7.23	7.25	7.32
7.45	7.49	7.55	8.01	8.06	8.09	8.11	8.18
8.30	8.34	8.40	8.46	8.51	8.54	8.56	9.03
9.15	9.19	9.25	9.31	9.36	9.39	9.41	9.48
10.00	10.04	10.10	10.16	10.21	10.24	10.26	10.33
10.45	10.49	10.55	11.01	11.06	11.09	11.11	11.18
11.30	11.34	11.40	11.46	11.51	11.54	11.56	12.03
<b>12.15</b>	<b>12.19</b>	<b>12.25</b>	<b>12.31</b>	<b>12.36</b>	<b>12.39</b>	<b>12.41</b>	<b>12.48</b>
<b>1.00</b>	<b>1.04</b>	<b>1.10</b>	<b>1.16</b>	<b>1.21</b>	<b>1.24</b>	<b>1.26</b>	<b>1.33</b>
1.45	1.49	1.55	2.01	2.06	2.09	2.11	2.18
2.30	2.34	2.41	2.47	2.52	2.55	2.58	3.05
3.15	3.19	3.26	3.32	3.37	3.40	3.43	3.50
4.00	4.04	4.11	4.17	4.22	4.25	4.28	4.35
4.45	4.49	4.56	5.02	5.07	5.10	5.13	5.20
5.30	5.34	5.41	5.47	5.52	5.55	5.58	6.05
6.15	6.19	6.26	6.32	6.37	6.40	6.43	6.50
7.00	7.04	7.11	7.17	7.22	7.25	7.28	7.35
7.45	7.49	7.56	8.02	8.07	8.10	8.13	8.20
8.30	8.34	8.41	8.46	8.51	8.53	8.55	9.03
9.15	9.19	9.26	9.31	9.36	9.38	9.40	9.48
10.00	10.04	10.11	10.16	10.21	10.23	10.25	10.33

## SATURDAY SOUTH

6	5	4	3	2	1
UNIVERSITY CITY	WOODRUFF & COLLEGE	COLLEGE & 12TH	12TH & CANCER CLINIC	NEIL & 5TH	COLLINS & THURBER
			5.56	6.00	6.05
			6.41	6.45	6.50
			8.11	8.15	8.20
			8.56	9.00	9.05
		6.34	6.41	6.45	6.50
6.22	6.32	6.34	6.41	6.45	6.50
7.07	7.17	7.19	7.26	7.30	7.35
7.52	8.02	8.04	8.11	8.15	8.20
8.37	8.47	8.49	8.56	9.00	9.05
9.22	9.32	9.34	9.41	9.45	9.50
10.07	10.17	10.19	10.26	10.30	10.35
10.52	11.02	11.04	11.11	11.15	11.20
11.36	11.46	11.48	11.55	11.59	12.05
<b>12.21</b>	<b>12.31</b>	<b>12.33</b>	<b>12.40</b>	<b>12.44</b>	<b>12.50</b>
<b>1.05</b>	<b>1.15</b>	<b>1.17</b>	<b>1.24</b>	<b>1.28</b>	<b>1.34</b>
1.50	2.00	2.02	2.09	2.13	2.19
2.34	2.45	2.47	2.54	2.58	3.04
3.19	3.30	3.32	3.39	3.43	3.49
4.05	4.15	4.17	4.24	4.28	4.34
4.51	5.01	5.03	5.10	5.14	5.20
5.36	5.46	5.48	5.55	5.59	6.05
6.21	6.31	6.33	6.40	6.44	6.50
7.06	7.16	7.18	7.25	7.29	7.35
7.52	8.01	8.03	8.10	8.14	8.20
8.38	8.47	8.49	8.55	8.59	9.05
9.18	9.27	9.29	9.35	9.39	9.45

Information available  
in accessible formats  
upon request.

Light Type A.M. **Bold Type P.M.**  
 ALL BUSES ON THIS ROUTE ARE  
WHEELCHAIR LIFT EQUIPPED.

## SUNDAY NORTH

1	2	3	4	5	6	7	8
S. HIGH & E. BROAD	HIGH & NATIONWIDE	COLLINS & THURBER	NEIL & 5TH	12TH & CANCER CLINIC	COLLEGE & 12TH	WOODRUFF & COLLEGE	UNIVERSITY CITY
7.40	7.44	7.50	7.55	8.01	8.03	8.05	8.12
8.40	8.44	8.50	8.55	9.00	9.02	9.04	9.11
9.40	9.44	9.50	9.55	10.00	10.02	10.04	10.11
10.40	10.44	10.50	10.55	11.00	11.03	11.05	11.13
11.40	11.44	11.50	11.55	<b>12.00</b>	<b>12.03</b>	<b>12.05</b>	<b>12.13</b>
<b>12.40</b>	<b>12.44</b>	<b>12.50</b>	<b>12.55</b>	1.00	1.03	1.05	1.13
1.40	1.44	1.50	1.55	2.00	2.03	2.05	2.13
2.40	2.44	2.50	2.56	3.01	3.04	3.06	3.14
3.40	3.44	3.50	3.56	4.01	4.04	4.06	4.14
4.40	4.44	4.50	4.56	5.01	5.04	5.06	5.14
5.40	5.44	5.50	5.56	6.01	6.04	6.06	6.14
6.40	6.44	6.50	6.56	7.01	7.04	7.06	7.14

## SUNDAY SOUTH

6	5	4	3	2	1	7	8
UNIVERSITY CITY	WOODRUFF & COLLEGE	COLLEGE & 12TH	12TH & CANCER CLINIC	NEIL & 5TH	COLLINS & THURBER	HIGH & NATIONWIDE	N. HIGH & W. BROAD
7.18	7.27	7.29	7.36	7.40	7.46	7.52	7.55
8.18	8.27	8.29	8.36	8.40	8.46	8.52	8.55
9.18	9.27	9.29	9.36	9.40	9.46	9.52	9.55
10.18	10.27	10.29	10.36	10.40	10.46	10.52	10.55
11.18	11.27	11.29	11.36	11.40	11.46	11.52	11.55
<b>12.18</b>	<b>12.27</b>	<b>12.29</b>	<b>12.36</b>	<b>12.40</b>	<b>12.46</b>	<b>12.52</b>	<b>12.55</b>
1.18	1.27	1.29	1.36	1.40	1.46	1.52	1.55
2.18	2.27	2.29	2.36	2.40	2.46	2.52	2.55
3.18	3.27	3.29	3.36	3.40	3.46	3.52	3.55
4.18	4.27	4.29	4.36	4.40	4.46	4.52	4.55
5.18	5.27	5.29	5.36	5.40	5.46	5.52	5.55
6.18	6.27	6.29	6.36	6.40	6.46	6.52	6.55

Monthly pass discounts are available to participating employers through a federally approved pre-tax payroll deduction. For information, call the COTA Connection, 228-1776.

For information on MORPC's Guaranteed Ride Home Program call 1-888-742-RIDE (7433).

### REGULAR FARES, single trip

Local, Crosstown.....	\$1.50
Express .....	\$2.00
Transfer .....	FREE*
LINK Services .....	50¢
ADA Cardholders.....	FREE

\*FREE transfer included in base price upon request

### SPECIAL FARES, single trip

**Discount** (with Senior/Key ID Card) and Children 48" tall to 12 years of age.....75¢  
**Children** under 48" tall.....FREE  
 limit 3 with adult family member  
**DOES NOT INCLUDE GROUPS**

### PASSES, unlimited trips

<b>Monthly</b> , purchased in advance	
Local* .....	\$45.00
Express .....	\$62.00
Discount (with Senior/Key ID Card)	\$22.00
<b>DayPass</b> , unlimited trips	
Local* .....	\$3.50
purchased on vehicle	
Discount (with Senior Key ID Card) and Children 48" tall to 12 years of age ....	\$1.75
purchased in advance	
<b>7-Day Pass</b> , purchased in advance	
Local* .....	\$18.00

\*Additional 50¢ required to ride Express bus with Local pass on each express bus trip.

**PLEASE HAVE EXACT FARE  
DRIVERS CARRY NO CASH**

Fares subject to change.

7

Serving  
**Neil Avenue  
LOCAL**

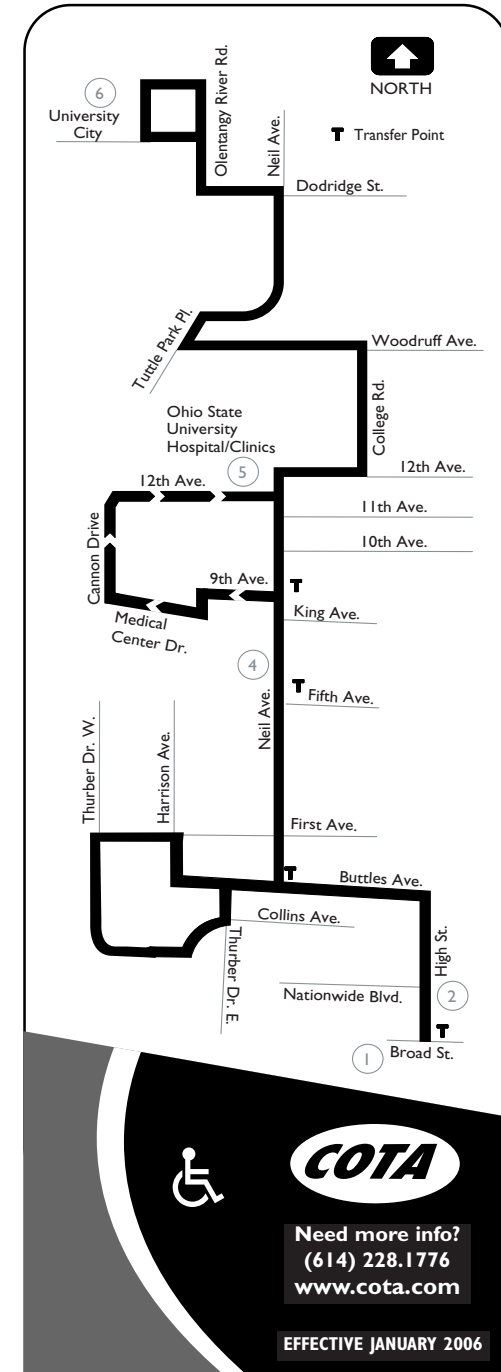

**Need more info?**  
(614) 228.1776  
[www.cota.com](http://www.cota.com)

EFFECTIVE JANUARY 2006

Light Type A.M. **Bold Type P.M.**



ALL BUSES ON THIS ROUTE ARE  
WHEELCHAIR LIFT EQUIPPED.