

84

Serving

Arlington/OSU Lennox/Grandview CROSSTOWN

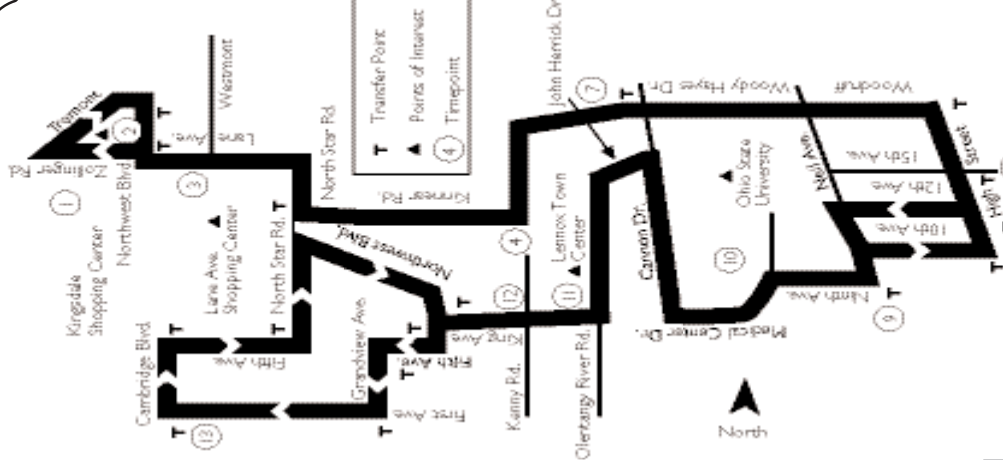

Need more info?
(614) 228.1776
www.cota.com

EFFECTIVE SEPTEMBER 2005

Monthly pass discounts are available to participating employers through a federally approved pre-tax payroll deduction. For information, call the COTA Connection, 228-1776. For information on MORPC's Guaranteed Ride Home Program call 1-888-742-RIDE (7433).

REGULAR FARES, single trip	
Local, Crosstown	\$1.25
Express	\$1.75
Transfer	10¢
LINK Services	.25¢
SPECIAL FARES, single trip	
Discount (with Senior Key/ADA ID Card) and Children 48 tall to 12 years of age	60¢
Children under 48 tall	FREE
limit 3 with adult family member	
DOES NOT INCLUDE GROUPS	
PASSES, unlimited trips	
Monthly, purchased in advance	
Local*	\$40.00
Express	\$55.00
Discount (with Senior Key/ADA ID Card)	\$18.00
DayPass, unlimited trips	
Local*	\$3.00
purchased on vehicle	
Discount (with Senior Key/ADA ID Card) and Children 48 tall to 12 years of age	\$1.50
purchased in advance	
7-Day Pass, purchased in advance	\$12.50
Local*	\$12.50
*Additional 50¢ required on each express bus.	
PLEASE HAVE EXACT FARE DRIVERS CARRY NO CASH	
Fares subject to change.	

#84 SERVING OSU/LENNOX

Monday-Friday SOUTH

Timepoints en route							
Lennox Town Center ⑤	John Herrick Dr. & Cannon Dr. ⑥	Woodruff & Tuttle Park	15th Ave. & High St. ⑧	Neil Ave. & Eleventh Ave.	Ninth Ave. & Medical Center Dr.	Cannon Dr. & John Herrick Dr. ⑥	Lennox Town Center ⑤
7:00	7:03	7:07	7:12	7:16	7:18	7:21	7:25
7:30	7:33	7:37	7:42	7:46	7:48	7:51	7:55
Every 30 minutes through							
1:30	1:33	1:37	1:41	1:44	1:46	1:48	1:51

(Week Nights)

Saturday SOUTH

Timepoints en route							
Lennox Town Center ⑤	John Herrick Dr. & Cannon Dr. ⑥	Woodruff & Tuttle Park	15th Ave. & High St. ⑧	Neil Ave. & Eleventh Ave.	Ninth Ave. & Medical Center Dr.	Cannon Dr. & John Herrick Dr. ⑥	Lennox Town Center ⑤
9:30	9:33	9:37	9:41	9:46	9:48	9:51	9:55
10:00	10:03	10:07	10:11	10:16	10:18	10:21	10:25
Every 30 minutes 8:30 am through 6:00pm							
6:15	6:18	6:22	6:26	6:31	6:33	6:36	6:40
Every 15 minutes 6:00 pm through 1:00 am							
1:00	1:03	1:07	1:11	1:14	1:16	1:18	1:21
1:30	1:33	1:37	1:41	1:44	1:46	1:48	1:51

(Sunday Morning)

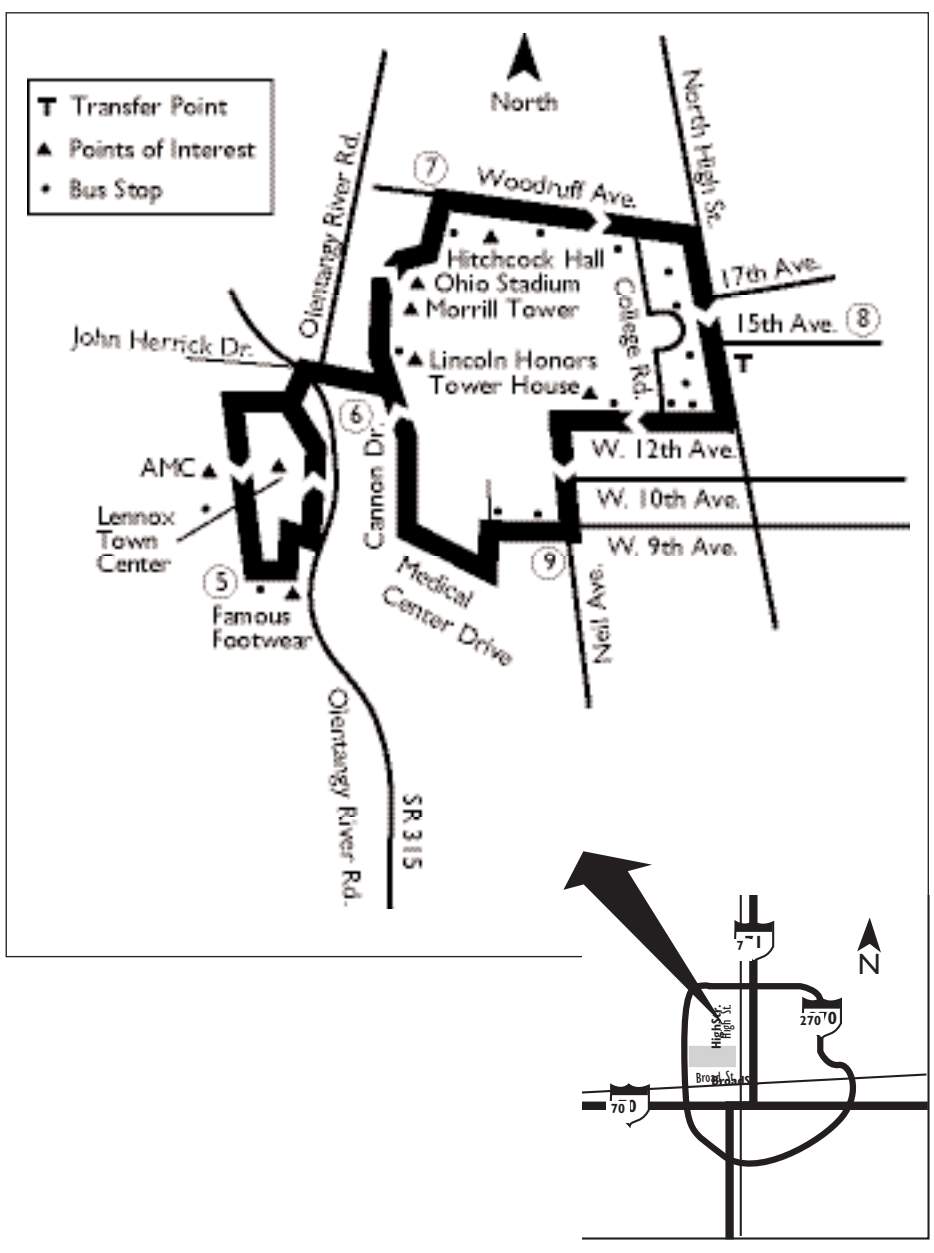

Sunday SOUTH

Timepoints en route							
Lennox Town Center ⑤	John Herrick Dr. & Cannon Dr. ⑥	Woodruff & Tuttle Park	15th Ave. & High St. ⑧	Neil Ave. & Eleventh Ave.	Ninth Ave. & Medical Center Dr.	Cannon Dr. & John Herrick Dr. ⑥	Lennox Town Center ⑤
9:30	9:33	9:37	9:41	9:46	9:48	9:51	9:55
10:00	10:03	10:07	10:11	10:16	10:18	10:21	10:25
Every 30 minutes through							
1:30	1:33	1:37	1:41	1:44	1:46	1:48	1:51

(Monday Morning)

Legend

Points of Interest:

Arlington, Kingsdale Shopping Center, Lane Avenue Mall, OSU, OSU Hospital, Battelle, Grandview, Lennox Town Center.

Light Type A.M. Bold Type P.M.

ALL BUSES ON THIS ROUTE ARE WHEELCHAIR LIFT EQUIPPED.

How to Get on COTA

Using this timetable

1. Find the day and direction you plan to travel.
(Example: Monday-Friday, North.)
2. Find the timepoint nearest your destination.
3. Read down that column to choose your arrival time at your destination.
4. Read across, to the left, to find your departure time.
(Your bus stop may not be listed. Use the timepoints to estimate your departure time.)

What's a timepoint?

Only timepoints, or major bus stops, are shown on this schedule. Use the timepoints to estimate your departure and arrival times from your bus stop.

What's a transfer point?

Bus stops where you can get off one bus, and get on another, are transfer points. Please check your timetables or call COTA Customer Service to find out where to make your transfer.

Call 228-1776

Still have questions? For COTA route and schedule information, call 228-1776. Tell us where you'd like to go, and we'll tell you how to get there!



Color bands on bus stop signs tell you whether the routes that stop here are local (black), express (red), or crosstown (green).

#84 SERVING ARLINGTON/OSU/LENNOX/GRANDVIEW

Monday - Friday NORTH

Timepoints en route										
13 Cambridge & First Ave.	12 King Ave. & Kenny Rd.	11 Lennox Town Center	9 Neil Ave. & Ninth Ave.	8 15th Ave. & High St.	7 Hayes Dr. & Cannon Dr.	4 Kenny Rd. & Kinnear Rd.	3 Lane Ave. Mall	2 Northwest & Zollinger	1 Kingsdale Park & Ride	
6.12	6.21	6.26	6.33	6.38	6.42	6.45	6.49	6.52	6.56	
6.58	7.08	7.14	7.21	7.26	7.30	7.35	7.40	7.43	7.47	
7.52	8.01	8.07	8.14	8.19	8.25	8.29	8.34	8.37	8.41	
8.43	8.52	8.57	9.03	9.08	9.13	9.17	9.22	9.25	9.28	
9.33	9.42	9.47	9.53	9.58	10.03	10.07	10.12	10.15	10.18	
10.23	10.32	10.37	10.43	10.48	10.53	10.57	11.02	11.05	11.08	
11.12	11.21	11.26	11.33	11.38	11.43	11.47	11.52	11.55	11.58	
12.07	12.16	12.21	12.28	12.33	12.38	12.42	12.47	12.50	12.53	
1.01	1.10	1.16	1.23	1.28	1.33	1.37	1.42	1.45	1.49	
1.54	2.04	2.10	2.17	2.23	2.29	2.33	2.38	2.41	2.45	
2.50	2.59	3.05	3.12	3.18	3.23	3.27	3.32	3.35	3.39	
3.46	3.55	4.01	4.08	4.13	4.18	4.22	4.27	4.31	4.35	
4.41	4.50	4.56	5.03	5.08	5.14	5.20	5.25	5.29	5.34	
5.34	5.44	5.50	5.58	6.03	6.08	6.11	6.16	6.20	6.25	
6.28	6.37	6.43	6.50	6.55	7.00	7.03	7.08	7.11	7.15	
7.18	7.27	7.33	7.40	7.45	7.50	7.53	7.58	8.01	8.05	

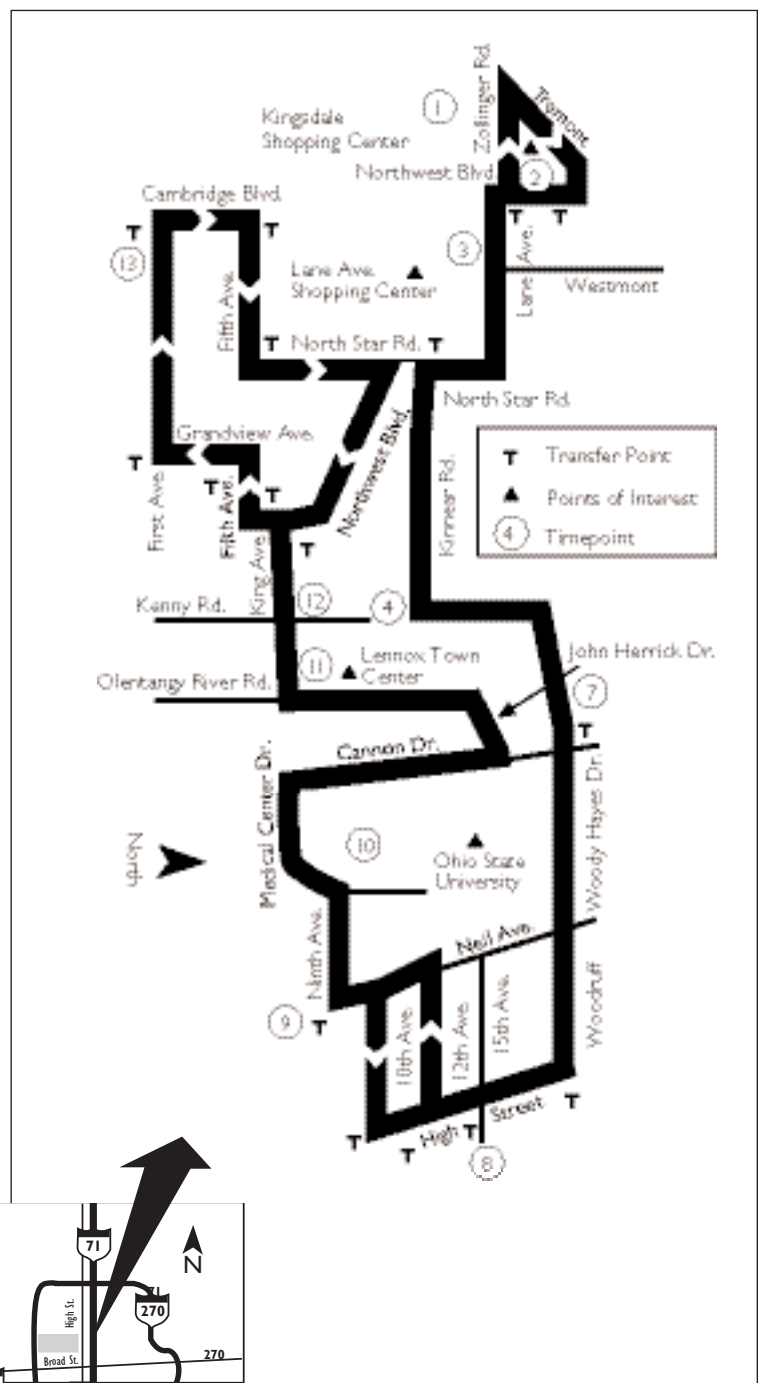

Monday - Friday SOUTH

Timepoints enroute										
1 Kingsdale Park & Ride	2 Northwest & Zollinger	3 Lane Ave. Mall	4 Kenny Rd. & Kinnear Rd.	Woodruff & Tuttle Park	8 15th Ave. & High St.	Neil Ave. & Eleventh Ave.	10 Ninth Ave. & Medical Center Dr.	11 Lennox Town Center	12 King Ave. & Kenny Rd.	13 Cambridge & First Ave.
6.12	6.13	6.16	6.21	6.25	6.30	6.34	6.36	6.42	6.45	6.53
7.05	7.06	7.09	7.14	7.19	7.24	7.27	7.29	7.35	7.38	7.45
7.54	7.55	7.58	8.04	8.09	8.14	8.17	8.19	8.25	8.28	8.35
8.44	8.45	8.48	8.54	8.59	9.04	9.07	9.09	9.15	9.18	9.25
9.34	9.35	9.38	9.44	9.49	9.54	9.57	9.59	10.05	10.08	10.15
10.25	10.26	10.29	10.34	10.39	10.44	10.47	10.49	10.55	10.58	11.06
11.14	11.15	11.18	11.23	11.28	11.34	11.37	11.39	11.45	11.48	11.56
12.09	12.10	12.13	12.18	12.23	12.29	12.33	12.35	12.41	12.44	12.52
1.03	1.04	1.07	1.13	1.19	1.24	1.29	1.31	1.38	1.41	1.49
1.58	1.59	2.02	2.08	2.14	2.19	2.24	2.26	2.33	2.36	2.44
2.53	2.54	2.57	3.03	3.09	3.14	3.19	3.21	3.28	3.31	3.39
3.48	3.49	3.52	3.58	4.04	4.09	4.14	4.16	4.23	4.26	4.34
4.44	4.45	4.48	4.54	5.00	5.04	5.09	5.11	5.19	5.22	5.30
5.39	5.40	5.43	5.49	5.55	5.59	6.04	6.06	6.14	6.17	6.25
6.31	6.32	6.35	6.41	6.45	6.49	6.53	6.55	7.02	7.05	7.13
7.20	7.21	7.24	7.29	7.33	7.38	7.42	7.44	7.51	7.54	8.02

Legend

Points of Interest:
Arlington, Kingsdale Shopping Center, Lane Avenue Mall, OSU, OSU Hospital, Battelle, Grandview, Lennox Town Center.

Light Type A.M. Bold Type P.M.

ALL BUSES ON THIS ROUTE ARE WHEELCHAIR LIFT EQUIPPED.